

Avex® 1604



English	Français	Deutsch	Italiano	Español
120° Countersunk head	120° Tête fraisée	120° Senkkopf	120° Testa svasata	120° Cabeza avellanada
Body: Aluminium alloy* (2.5 % Mg) Natural	Corps: Alliage d'aluminium* (2.5% Mg) Brut	Hülse: Aluminium* (2.5 % Mg) Blank	Corpo: Lega di alluminio* (2.5% Mg) Nessuna finitura	Cuerpo: Aluminio* (2.5% Mg) Natural
Stem: Low carbon steel**	Tige: Acier bas carbone**	Dorn: Stahl**	Gambo: Acciaio a basso tenore di carbonio**	Vástago: Acero bajo en carbono**
Zinc coated	Revêtement zingué	Verzinkt	Zincato	Zincado

*: AA 5052, DIN 1725, AlMg2.5, Werkstoff 3.3523

** : BS3111 Type 0, SAE 1015/1018/1022, DIN 1654, Cq15/Cq22

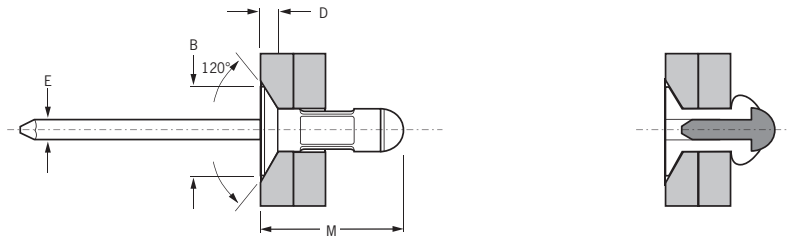

ø					M	B	D	E			Part No/ref
	nom.	min.	max.	min.							
3.2 (1/8")	2.4	6.3	3.3	3.4	12.2	5.5	1.3	1.8	0.7	1.0	01604-00412
	4.0	7.9			13.4						01604-00414
	5.5	9.5			14.8						01604-00416
4.0 (5/32")	2.8	7.9	4.1	4.2	14.3	6.5	1.4	2.2	1.1	1.3	01604-00514
	3.6	8.8			15.1						01604-00515
4.8 (3/16")	3.2	7.9	4.9	5.0	15.5	9.0	1.8	2.9	1.5	2.3	01604-00615
	6.3	12.7			20.4				1.3		01604-00621

all dimensions in mm / en millimètre / alle Maße in mm / in millimetri / en milímetros

1) typical values / valeurs moyennes / typische Werte / Valori tipici / resistencias máximas recomendadas



An Acument™ Global Technologies Company

www.avdel-global.com

© 2007 Acument Intellectual Properties, LLC

Avex® is a trademark of Avdel UK Limited

03.2007

Data shown is subject to change without prior notice as a result of continuous product development and improvement policy.
Your local Avdel representative is at your disposal should you need to confirm latest information.